

BT - 10TW series

Bluetooth wireless barcode scanner

WATERPROOF



LOW temperature

-2°C / 28.4°F



High temperature

59°C / 138°F



Shock resistance



Scratch resistance



With aggressive scanning capabilities and the ability to read a wide range of barcode formats, the BT-10L accurately captures data fast, helping employees work quickly and efficiently.

Users will be up and running fast, because the BT-10L is easy to deploy, thanks to its advanced blue tooth connectivity technology and user-friendly design. It provides rapid data transmission capacity.

High Power



Also, special features such as the ability to pair with smart devices help eliminate the possibility of data loss while transmitting.

**easy trigger
longer useful life**

Touch trigger



Introduction

The BT-10 series handheld barcode scanner from Suntop is a portable device that offers high performance scanning at a moderate price point. features such as the ability to pair with smart devices help eliminate the possibility of data loss while transmitting.

From backroom inventory management to logistics and package tracking to point-of-sale scanning, the BT-10L provides fast reliable scanning, increasing productivity and efficiency while reducing your total cost

**Special occasions
hospital, library...etc**



BT - 10TW SERIES FEATURES

Applications



Document tracking Retail Store Logistics/Delivery Ticket/Labels Medical attention Industry



Performance/ Bluetooth

Fast and fuzzy decoding capability to read deformed or bad printed barcodes.
 Portable, wireless scanner is suit for many types business.
 The Communication coverage 10m/ 33ft line of sight, give you more flexible working environment to

Compatible with 3 Systems/ 5 devices

BT-10 series could be pair with many devices, such as Tablet PC, Smart phones, Notebook, MAC, Desktop. Android, iOS and Windows systems are compatible, too.
 It will give users more convenience to raise their efficiency.



Low temperature conditions

The scanner into fridge keeps operating under 0°C/32°F and the device works smoothly and fine, even could under -2°C/28.4°F.



High temperature conditions

The scanner into oven keeps operating over 50°C/122°F and the device works smoothly and fine, ever could over 59°C/138°F.



Waterproof

BT 10 could operate fine under the rain, wet area or any torture environment. The precise units inside are not affected by water.

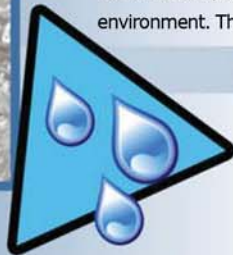

Germproof

BT 10 is waterproof, also could use Alcohol disinfection, germproof material let people use hygienically.



Touch Trigger

Trigger useful longer life, and better way to against water & humidity..



High capacity battery

SANYO 18500 1620mAh high capacity battery gives you over 8 hours operating and standby over 3 days.



Ergonomics design

Understanding LED Notification let you easy to control the working conditions.

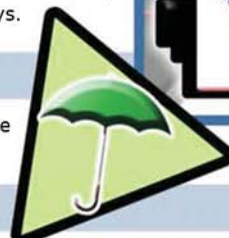

Safety mechanism

Scratch resistance and Shock resistance design give scanner more protected and the user could save more cost. 3 protections of Battery mechanisms let user don't have to worry about the quality.

Specifications

Laser Scanner
BT-10LTW

Long Range CCD Scanner
BT-10RTW

MECHANICAL CHARACTERISTICS

Introductions

Dimensions



- Search LED
- Connected LED
- Low Power LED
- Charging LED
- Reading LED
- Trigger Key
- Power Key

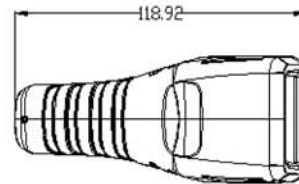
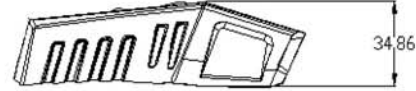
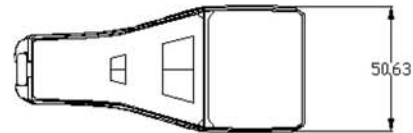
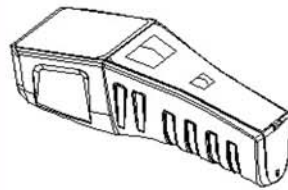

Weight	110g	
LED Notification	Reading LED (Green) and Connected LED(Blue), Low Power (Red)	
Input	Scan and Power On/Off	
Battery	Battery Type	SANYO 18500, 1620mAh
	Battery Life	Standby over 3 days · Normal operating time over 8 hours
	Charging Time	4 hours for a full charge
Power Consumption	Trigger mode: 90 mA (scanning), 15 mA (standby)	Trigger mode: 70 mA (scanning), 15 mA (standby)

PERFORMANCE CHARACTERISTICS

Light Source	650 nm visible laser diode	RED LED (wavelength 630nm)
Scan Speed	100 scan lines per second	
Scan Angle	42°± 2 nominal	
Depth of Field	0 ~ 50 cm	0~20cm
Print Contrast	0.3 minimum reflectance difference	
Resolution	>0.1mm	
Decode Capability	UPC/EAN/JAN with add-on 2/5, Code 39 full ASCII, Code 128, Codabar, Code 93, Code 11, ITF 2/5, MTX 2/5, IND 2/5, ISBN/ISSN, China Postage, MSI/Plessey, IATA	

BLUETOOTH

Bluetooth Protocol	Bluetooth 2.1 + EDR (Enhanced Data Rates)
Bluetooth Radio Range	3ft /10M
Bluetooth Profile Support	HID (Human Interface Device)

USER ENVIRONMENT

*Impact resistance	During operating temperature, 1.5m/4.9ft around 6 drops onto concrete
Operating Temperature	32°F~104°F / 0°C~40°C
Storage Temperature	-40°F~158°F / -40°C~70°C
Humidity	10%~95% (non-condensing)

ELECTRICAL SAFETY

Laser Class	CDRH Class II
EMC	FCC class B
*Ingress Protection:	IP66



Accessories:

Charging Cable, Hand Strap, Setting Card come with products.



Specifications subject to change without notice.
Copyright September 2012. Suntop, All rights reserved.